

RECOMMENDED P.C.B. LAYOUT

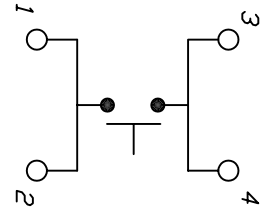

CIRCUIT: SPST
CONTACT CONFIGURATION

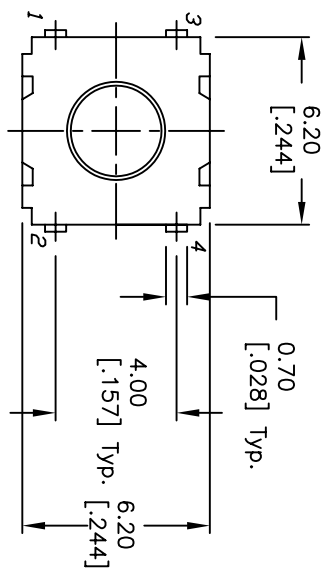
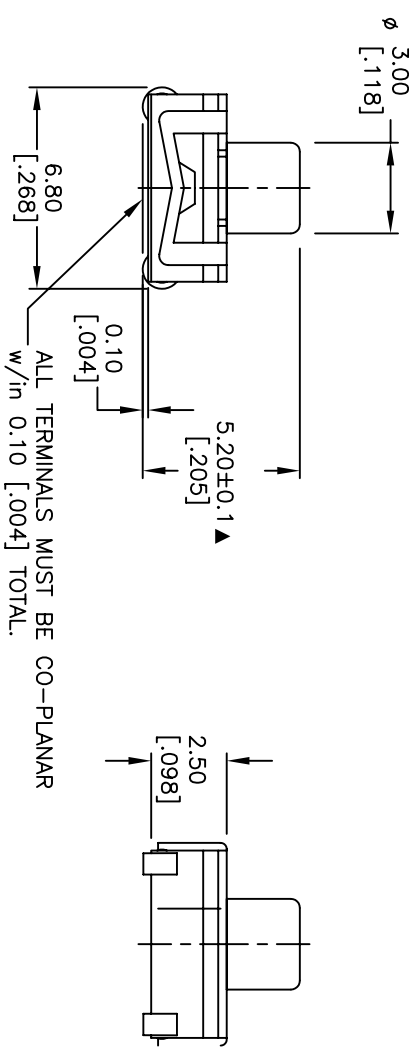

ALL TERMINALS MUST BE CO-PLANAR w/in 0.10 [0.004] TOTAL.

- NOTES:
1. ALL DIMENSIONS IN MM [INCH]
 2. GENERAL TOLERANCE: X.X=±0.4 X.XX=±0.25
 3. TERM. NOS. FOR REF. ONLY
 4. RATING: 50mA, @12V DC
 5. OPERATING FORCE: 200gf
 6. TRAVEL: 0.25 +0.2/-0.1mm
 7. CONTACT RESISTANCE: 20 MILLIOHMS INITIAL.
 8. ELECTRICAL LIFE: 100,000 CYCLES
 9. ▲ DENOTES CRITICAL PARAMETER.
 10. PACKAGING: TAPE AND REEL.
 11. PART TO PASS E-SWITCH SEAL TEST. (B)
 12. 2002/95/EC (ROHS) COMPLIANT

E	16822	UPDATED NOTES, REMOVED NOTE	1/3/07	TN
D	15487	REMOVE GOLD DOME INFO	11/2/05	PH
C	15461	GOLD DOME INFO	10/26/05	PH
B	14482	ADD EPOXY NOTE AND NOTE 11	11/10/04	AR
A	13918	RELEASED FOR PRODUCTION	4/15/04	AR
REV.	ECN No.	DESCRIPTION	DATE	CHKD

THE INFORMATION CONTAINED IN THIS DOCUMENT IS PROPRIETARY TO E-SWITCH AND IS NOT TO BE COPIED OR TRANSMITTED



TL6304BF2000J

SCALE	4:1	DATE	1/3/2007	DR	TN	DWG	D310744	REV	E
TITLE	TL6304BF2000J								